



# COLLINS

## Manufacturing Corp.

PO Box 1299 \* Jacksonville, OR 97530

E-mail: collinsdollies@aol.com  
 TOLL FREE (800) 332-9220  
 OFFICE (541) 774-9220  
 FAX (541) 774-9222

### Hi-Speed®Dolly Frame Breakdown (Exploded View)

Item	Part No.	Model Dolly	Left & Right	Description
A	DFX-SLX			DOLLY FRAME SLX
B*	DFX-SA/L		* Left	SPINDLE ASSEMBLY/LEFT
B*	DFX-SA/R		* Right	SPINDLE ASSEMBLY/RIGHT
C*	DFX-TA/L		* Left	TRIP ASSEMBLY/LEFT
C*	DFX-TA/R		* Right	TRIP ASSEMBLY/RIGHT
D	DFX-RAB			RATCHET ASSEMBLY BODY
E*	DF-RS/L		* Left	RATCHET SPRING/ LEFT
E*	DF-RS/R		* Right	RATCHET SPRING/RIGHT
F	DFX-RC			RATCHET CAM
G	DFX-RSB			RATCHET ASSEMBLY SHOULDER BOLT
H	DFX-SLN			SPINDLE LOCK NUT
I	DF-GZ			GREASE ZERK
J*	DF-TS/L		* Left	TRIP SPRING/LEFT
J*	DF-TS/R		* Right	TRIP SPRING/RIGHT
K	DF-SLP			SAFETY LOCK ROLL PIN
L	DF-SLH			SAFETY LOCK HANDLE
M	DF-SLB			SAFETY LOCK BALL BEARING
N	DF-SLS			SAFETY LOCK SPRING
O	DF-SLZ			SAFETY LOCK GREASE ZERK
P	DFX-TSB			TRIP ASSEMBLY SHOULDER BOLT
Q	DFX-SSB			SPINDLE ASSEMBLY SHOULDER BOLT
R*	DFX-RA/L		* Left	RATCHET ASSEMBLY/ LEFT
R*	DFX-RA/R		* Right	RATCHET ASSEMBLY/RIGHT

### Hi-Speed SLX

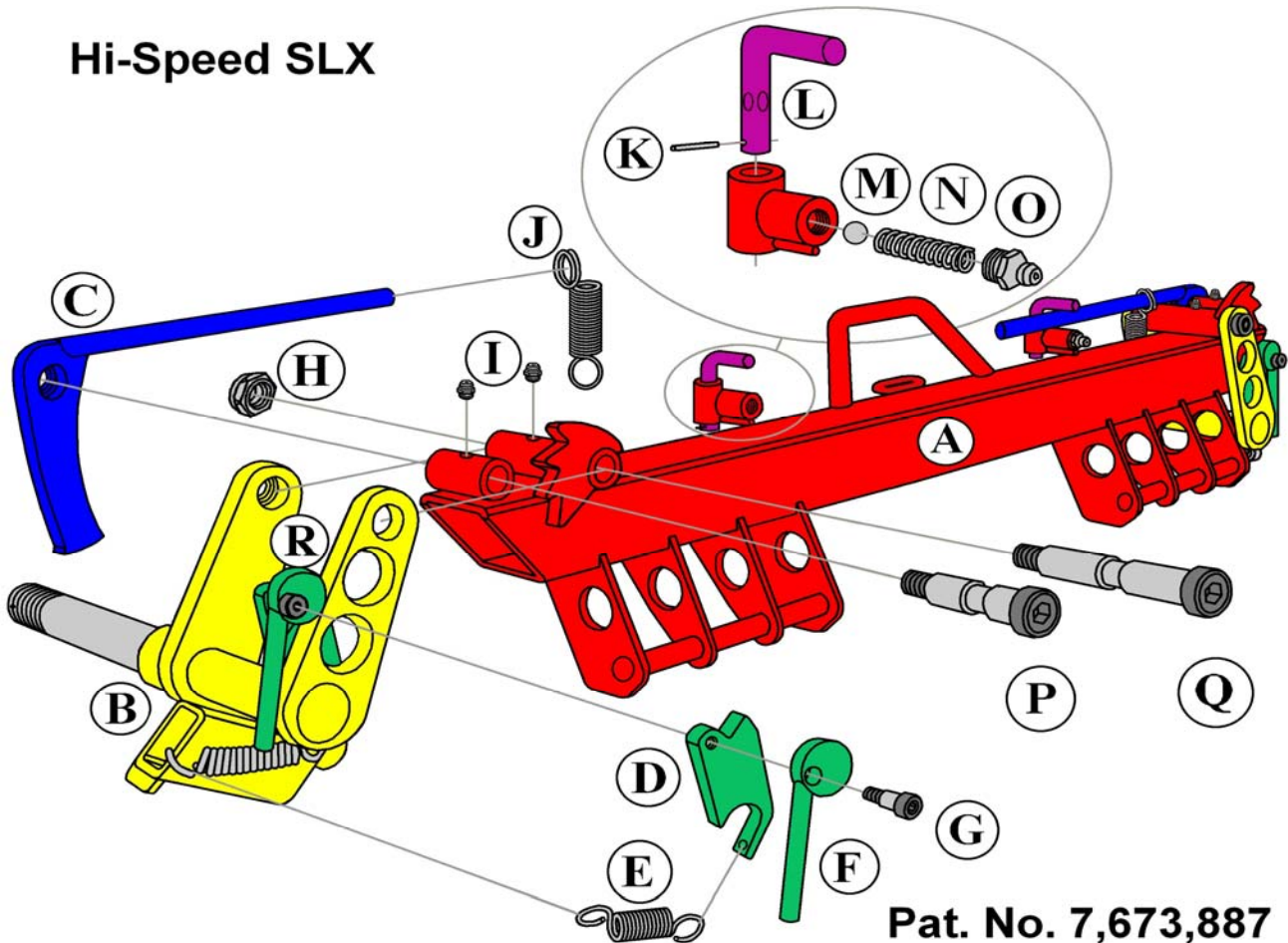

Pat. No. 7,673,887